

22" GASKETED
LOCKING LID

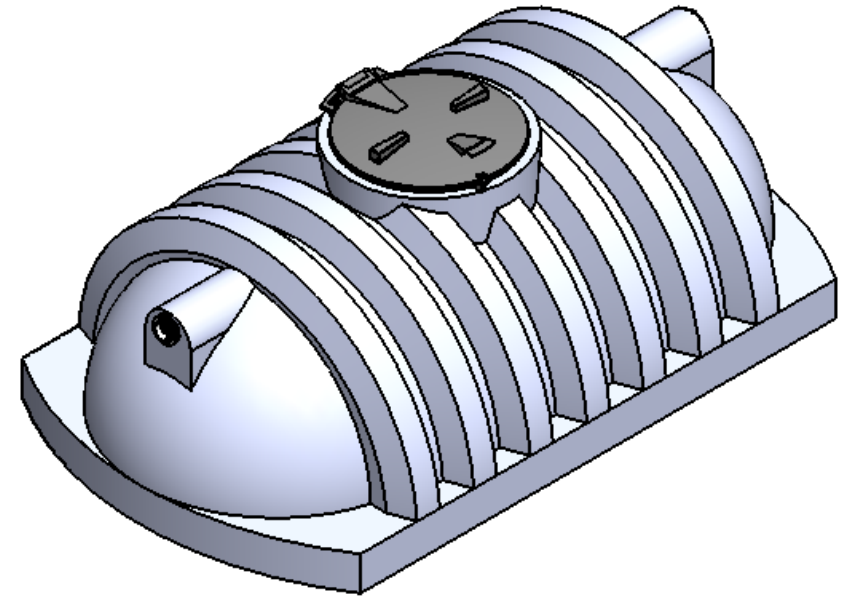

NOTES:

1. MATERIAL: HDPE
2. MOLDED WT. 215 LBS.
3. CAPACITY: APPROX. 500 GALLONS.
4. SEE INSTALLATION INSTRUCTIONS

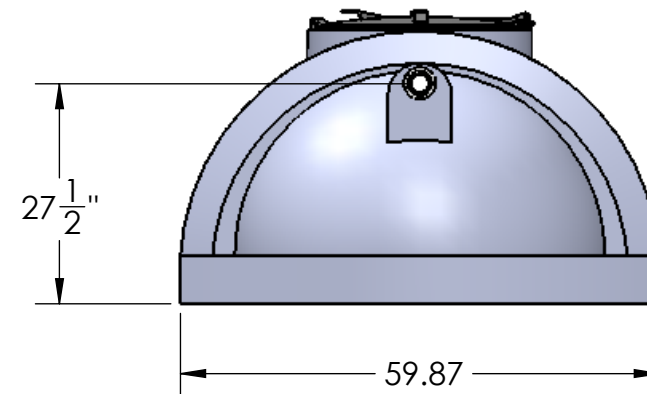
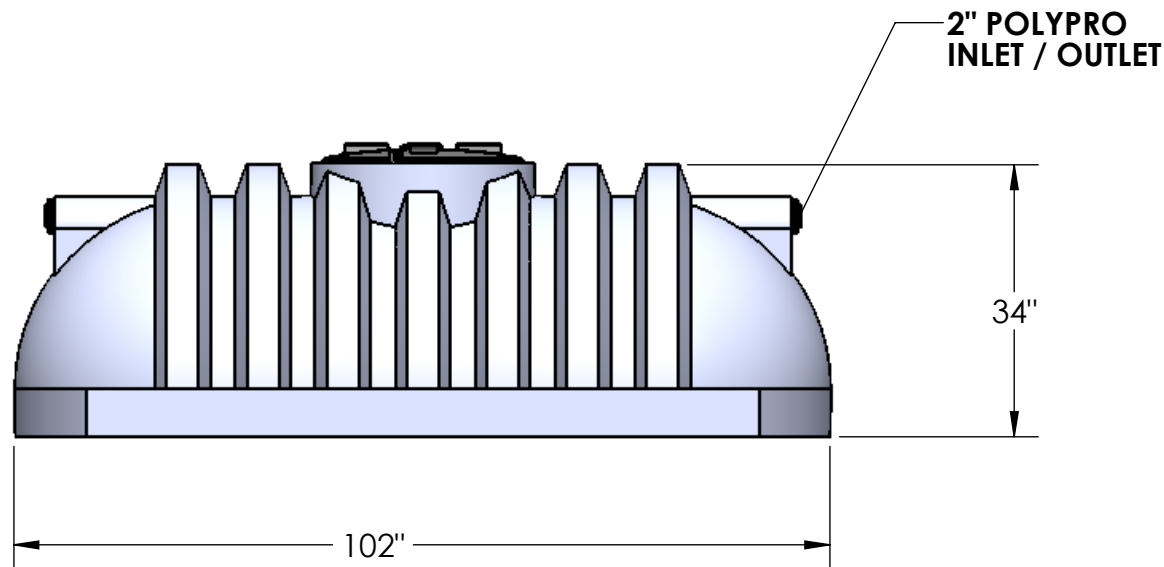

PROPRIETARY AND CONFIDENTIAL

THE INFORMATION CONTAINED IN THIS DRAWING IS THE SOLE PROPERTY OF <INSERT COMPANY NAME HERE>. ANY REPRODUCTION IN PART OR AS A WHOLE WITHOUT THE WRITTEN PERMISSION OF <INSERT COMPANY NAME HERE> IS PROHIBITED.

UNLESS OTHERWISE SPECIFIED:

DIMENSIONS ARE IN INCHES
TOLERANCES:
FRACTIONAL ±
ANGULAR: MACH ± BEND ±
TWO PLACE DECIMAL ±
THREE PLACE DECIMAL ±

INTERPRET GEOMETRIC
TOLERANCING PER:

MATERIAL

FINISH

DO NOT SCALE DRAWING

DRAWN

CHECKED

ENG APPR.

MFG APPR.

Q.A.

COMMENTS:

NAME

EBW

DATE

10-23-14

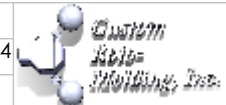

TITLE:

500 GALLON CISTERN TANK

SIZE

DWG. NO.

B

500 CT

REV

SCALE: 1:24 WEIGHT:

SHEET 1 OF 1